

The CAFRE Trail

WALKS

- Red route = 1.5 miles
- Yellow route = 1.2 miles
- White route = 0.5 miles

KEY FEATURES

- 1 Disabled parking and toilets
- 2 Ice house
- 3 Stone arch and pond
- 4 Temple lake and bird hide
- 5 BBQ area and toilets
- 6 Constructed wetlands system and wild flower meadow
- 7 Sand Martin nesting wall
- 8 Apiary
- 9 Summer house ruins
- 10 Avenue lake and bridge
- 11 The Richardsons Walled Garden



Greenmount Campus

The Richardsons Walled Garden

KEY FEATURES

- 1 Walled Garden Studio
- 2 Garden Offices
- 3 Floristry Studios
- 4 Pergola & Gazebo
- 5 Celtic Knot Gardens
- 6 Central Pool & Sculpture
- 7 Pleached Lime Trees
- 8 Hot Garden
- 9 Conservatory & Parterre
- 10 Potager (Vegetable Garden)
- 11 Beech Maze
- 12 DARD Rose Garden
- 13 Wildlife Garden
- 14 The BBC Greenmount Garden
- 15 Woodland Walk
- 16 Pond Dipping Platform

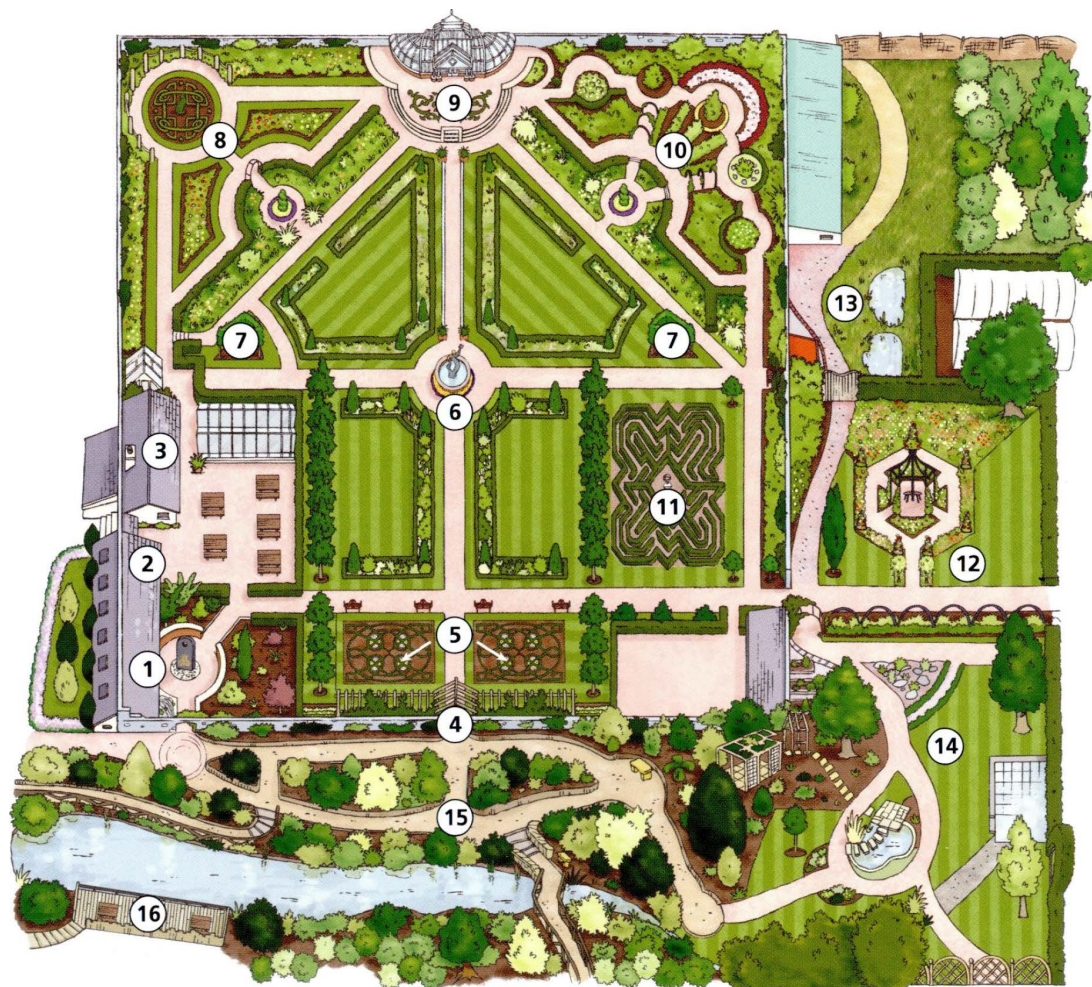

WALLED GARDEN HISTORY

The Walled Garden at Greenmount was constructed in 1801 as evidenced by the keystone above the arch. In this era walled gardens were built primarily to provide an encouraging microclimate for fruit, vegetable and flower production. This garden once produced exotic fruits such as grapes and pineapples.

Walled gardens required large numbers of highly skilled gardeners to maintain them and consequently most fell into dereliction at the beginning of the 20th century as the cost of labour rose.

With the founding of Greenmount College in 1912, this garden was developed to train students in horticulture and consequently there was sufficient manpower to keep it in full commercial production.

The garden remained fully operational up to the mid 1980s until new production units at the college gradually replaced the older facilities within the walled garden thus leaving it somewhat redundant.

RECENT DEVELOPMENTS

The Walled Garden was redeveloped for the millennium. Greenmount designed the garden, provided the site, technical expertise and labour while Richardsons Fertiliser (IFI) provided financial support.

The garden has a dramatic, formal framework integrated with softer plantings. Formal plant features such as knot gardens, box edgings, yew obelisks, pleached lime trees and rose beds contrast with loose and colourful mixed borders and an ornamental fruit and vegetable garden.

A grand curvilinear style glasshouse is located on the west facing wall. The parterre in front is linked via a step cascade and flowing rills to a bronze sculpture within the central circular pond.

The garden serves as an excellent outdoor classroom for Horticulture students who as part of their studies maintain, nurture and continue to develop the garden to its full potential.